

# WIRELESS TELEMETRY LOAD PIN

## DESCRIPTION

The Wireless Telemetry Load Pin is a strain gauged pin with a local battery powered wireless transceiver which communicates with our AWS Wireless Telemetry Load Measurement System. With a simple to change extra-long life battery, and a large range of load capacities, it is ideal for applications in systems where running cables to a load pin is not possible. The transceiver can be mounted within 3m of the Load Pin, in an easy to access location for battery changing.

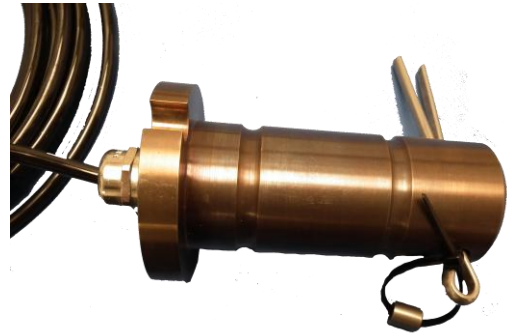

## SPECIFICATIONS

- Stainless Steel
- Strain Gauged Internally
- Capacity 25 Te
- 5 Step Linearisation
- 3m cable from Load Pin to its transceiver
- Auto Power Down
- Transmission Distance up to 200m
- Sealed to IP67
- Meets the CE RED directive, & FCC regulations.

## FEATURES & BENEFITS

- Long battery life
- Error free data transmission
- Active repeater to extend transmission range
- Remote on/off
- Environmentally sealed
- Other capacities available on request

Specification		
Capacity	5-1000	tonne
Radio Frequency	2.4	GHz
Accuracy (above 10% of FSD)	±0.05	% of reading
Compensated Temp. Range	-10 to +40	°C
Operating Temp. Range	-20 to +60	°C
Temp. Coefficient on Zero	<0.005	% FRO/°C
Temp Coefficient on Span	<0.003	% FRO/°C
Safe Overload	150	%

## DIMENSIONS

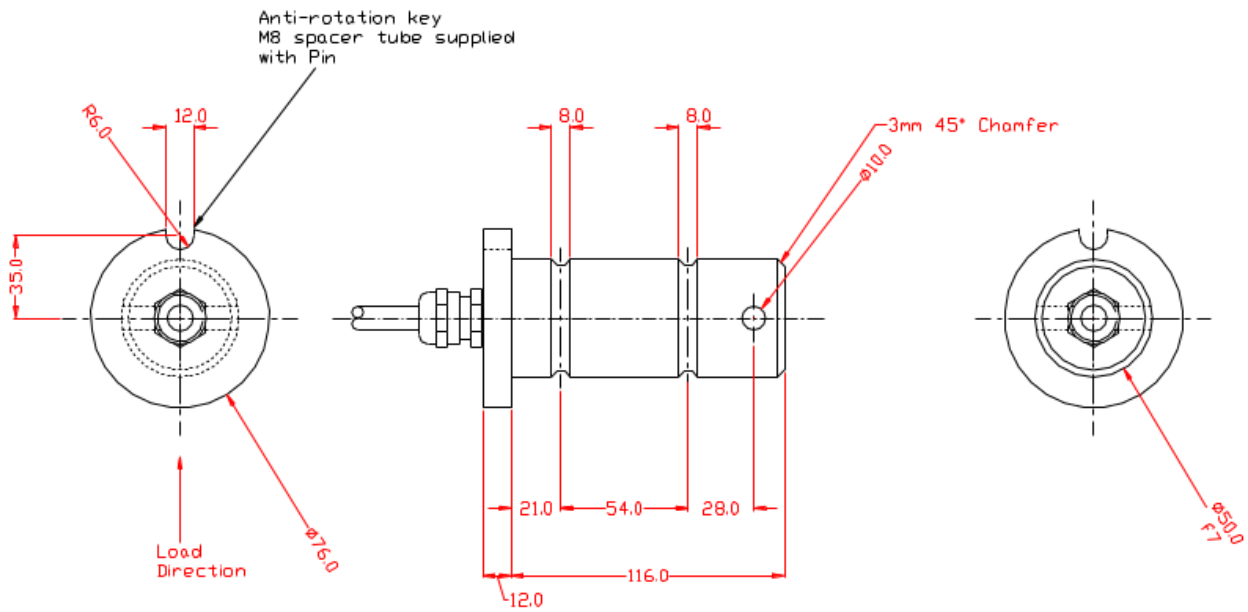

Advanced Witness Systems Ltd © 2023

### MANUFACTURER INFORMATION

Advanced Witness Systems Ltd  
Unit 8  
Beaumont Business Centre  
Beaumont Close  
Banbury  
OX16 1TN  
Tel: +44 (0)1295 266939  
Email: sales@awstorque.co.uk

### SUPPLIER INFORMATION