

1Nm INTELLIGENT IN-LINE TORQUE TRANSDUCER

DESCRIPTION

The AWS LTD Intelligent In-Line Torque Transducer range (IITT), is designed to accurately measure torque values, in a variety of industries.

With optimised torque ranges, the transducer contains our Intelligent Instrumentation Package, outputting using CAN-BUS protocol to communicate with the AWS LTD Professional Transducer Display (PTD). This digital communication eliminates signal loss when using long lengths of cable, providing flexibility in communicating with other devices and systems.

There is an option (using the In-line Transducer Mounting Bracket, purchased separately) to bench mount the transducer in either a vertical or horizontal position.

This transducer is either Male SQ drive to Male SQ drive or Male SQ drive to HEX drive. There are 2x M4 threaded holes in the reaction end and bottom surfaces for bolting.

A simple 2 step calibration.

Stores serial & model number, capacity, calibration coefficient, units of calibration, and conversion to other torque units.

SPECIFICATIONS

Model: IITT-	1112	1112H	1111	1111H	1018	1018H
Ranges:	0.01 - 0.25Nm	0.01 - 0.25Nm	0.02 - 0.5Nm	0.02 - 0.5Nm	0.04 – 1Nm	0.04 – 1Nm
Drive Size:	1/4" SQ	1/4" HEX	1/4" SQ	1/4" HEX	1/4" SQ	1/4" HEX

Accuracy: Better than 0.1% of reading from 10 to 100% of rated output. See calibration certificate for full results.

Modes: **Run:** For Dial-type and Electronic Wrenches and Screwdrivers.

Peak: For Cam-type Wrenches and Screwdrivers.

1st Peak: For Click-type Wrenches and Screwdrivers, retains reading until manually cancelled or for 3 seconds if auto cancel option is chosen.

Communication: Communications via canbus (use with AWS PTD-1010 power & display unit).

Overload Capacity: 120%

Power and Display: Requires only a single D.C. power supply (use with AWS PTD-1010, power and display is provided).

Maximum mechanical overload: 150%

Operating Temperature: -10°C to +50°C.

Connector: Mil C 26482 series.
6 pin. Shell size 10.

CE: 2014/30/EU

EMC: BS EN 61326:2007



DIMENSIONS

Dimensions for IITT-1112 available on request.

Model	Dimension (mm)								
	A	B	C	D	E	F	G	H	I
IITT-1111	82	55	40	25	25	10	12	16	44
IITT-1018	82	55	40	25	25	10	12	16	44

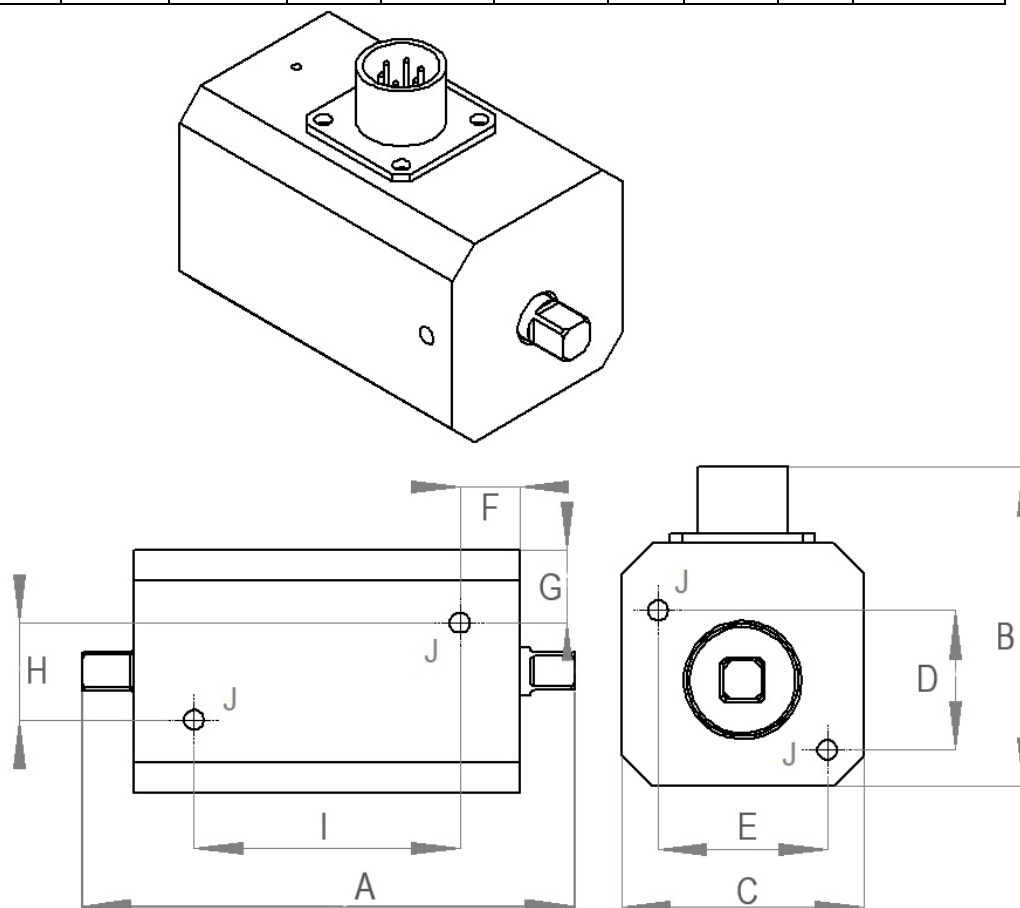

Mounting Tapped Hole "J"	Square Drive	Weight (Kg)
M4	Male 1/4"	0.3

Advanced Witness Systems Ltd © 2025

MANUFACTURER INFORMATION

Advanced Witness Systems Ltd
Unit 8
Beaumont business Centre
Beaumont Close
Banbury
Ox16 1TN
Tel: +44 (0)1295 266939
Email: sales@awstorque.co.uk

SUPPLIER INFORMATION

Data was correct at time of publication.
Catalogue Page 8